

Table of Contents

Do you have Microsoft Authenticator installed?	1
How to install Microsoft Authenticator from App Store	1
How to Set Up Microsoft Authenticator when not on Campus	2
How to Set Up Microsoft Authenticator when on Campus	11
Appendix - Trouble Shooting Tips.....	20
How to add Phone call or SMS if unable to install Microsoft Authenticator	20
How to add additional MFA methods (Phone Extension Example).....	24
How to install Microsoft Authenticator from Jefferson App Store	26
How to add a second phone to MS Authenticator	28
Phone/SMS Users - How to set up MS Authenticator MFA App for push notification	35
FAQs	42
App lock and how to disable it	42
What should I do if I get a random Microsoft Authenticator notification	42

Do you have Microsoft Authenticator installed?



1. If yes, skip to [How to Set Up Microsoft Authenticator](#)
2. If no, please continue to the next section

How to install Microsoft Authenticator from App Store

1. Go to your mobile device
2. Open the Apple App store for iOS or the Google Play Store for Android Devices
3. Search for “**Microsoft Authenticator**” download and install the app
4. If you need a direct link for the application, please use the following: [Apple app store](#) or [Google play store](#)
5. The app looks like this in the Apple Store and Google Play store. Please be careful as there are other authenticator apps that are not from Microsoft Corporation.

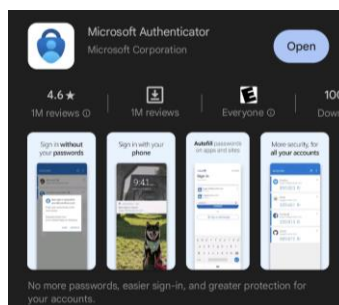
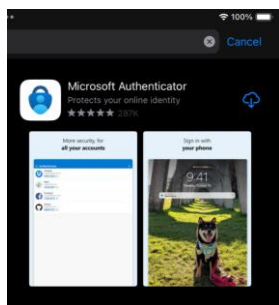

How to Set Up Microsoft Authenticator when not on Campus

1. Please make sure you are not on the Jefferson network and not connected to Jefferson's VPN. From a computer, open the browser and go to <https://mysignins.microsoft.com/security-info> to login.
2. You will be prompted to Sign in.
 - a. Enter your email in the format abc123@jefferson.edu or abc123@Jeffersonhealthplans.com or abc123@students.jefferson.edu

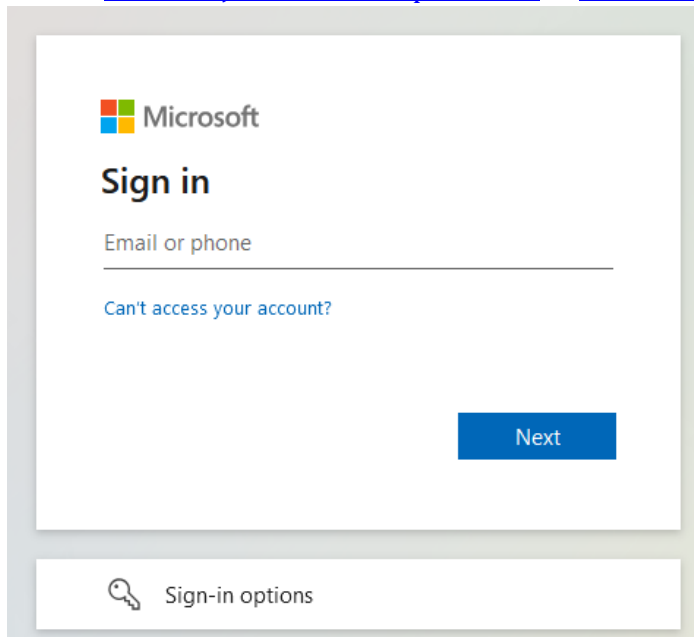
A screenshot of the Microsoft Sign in page. At the top is the Microsoft logo. Below it is the text "Sign in". There is a text input field labeled "Email or phone". Below the input field is a link that says "Can't access your account?". At the bottom right is a blue button labeled "Next". At the bottom left is a key icon and the text "Sign-in options".

3. Click **Next**

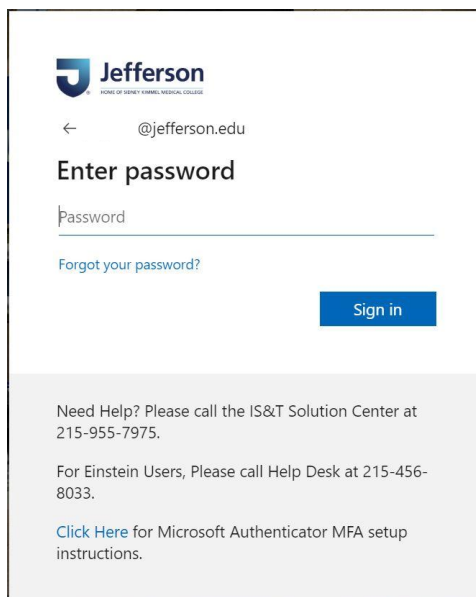
A screenshot of the Jefferson "Enter password" screen. At the top is the Jefferson logo with the tagline "HOME OF BETTER CARE. BETTER PEOPLE." Below it is a back arrow and the text "@jefferson.edu". The main heading is "Enter password". There is a text input field labeled "Password". Below the input field is a link that says "Forgot your password?". At the bottom right is a blue button labeled "Sign in". At the bottom, there is a grey box containing the following text: "Need Help? Please call the IS&T Solution Center at 215-955-7975.", "For Einstein Users, Please call Help Desk at 215-456-8033.", and "Click Here for Microsoft Authenticator MFA setup instructions.".

4. Enter your password
5. Click **Sign in**

6. A screen will appear saying **More information required**

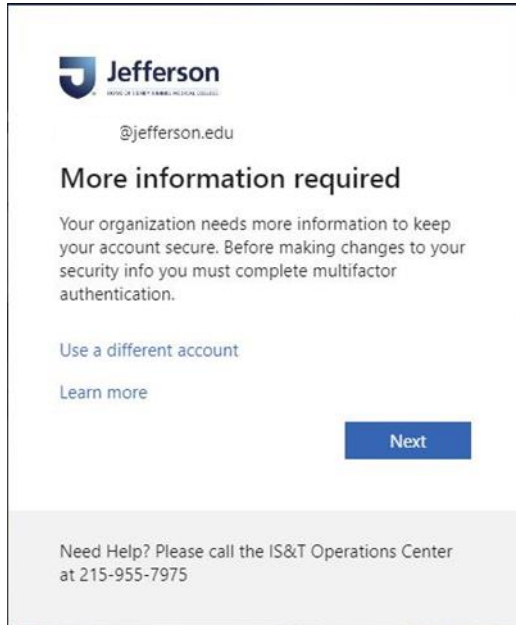

7. Click **Next**

8. You should have the **Microsoft Authenticator** app installed on your device. If not, please follow the prompts on the computer screen (see arrow below) or please see [How to install Microsoft Authenticator](#) or if you have a Jefferson issued Mobile Device [How to install Microsoft Authenticator from Jefferson App Store](#)

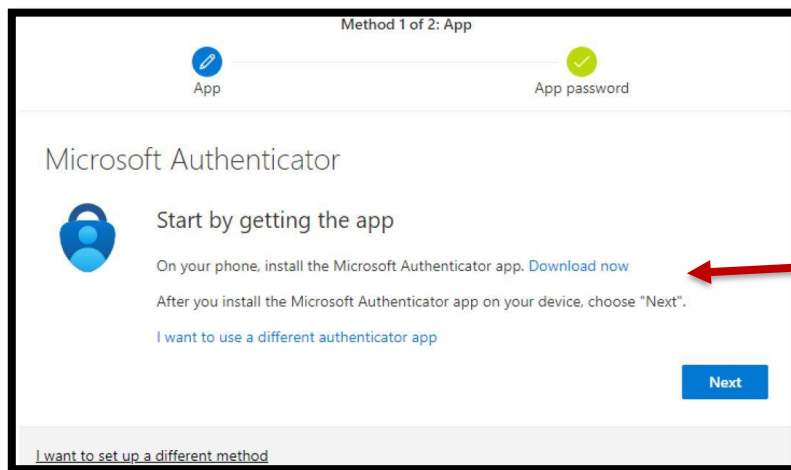

You can find more information about Microsoft Authenticator and where to download the app with this link.
<https://www.microsoft.com/en-us/security/mobile-authenticator-app?rtc=1>

Instructions continued on next page

9. Once you have the app installed, click **Next**

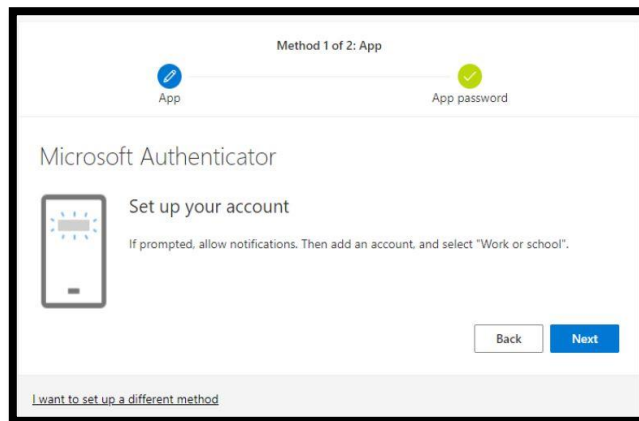

10. Now, go to your **mobile device** and open the **Microsoft Authenticator** app. If you have already used Microsoft Authenticator with another company or account, skip to step 14.

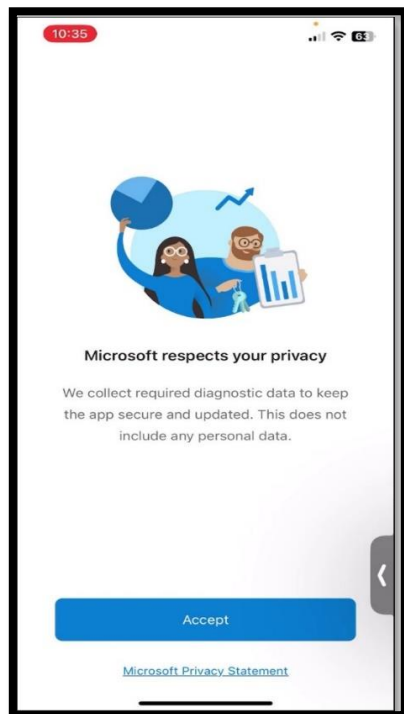

11. Click **Accept**

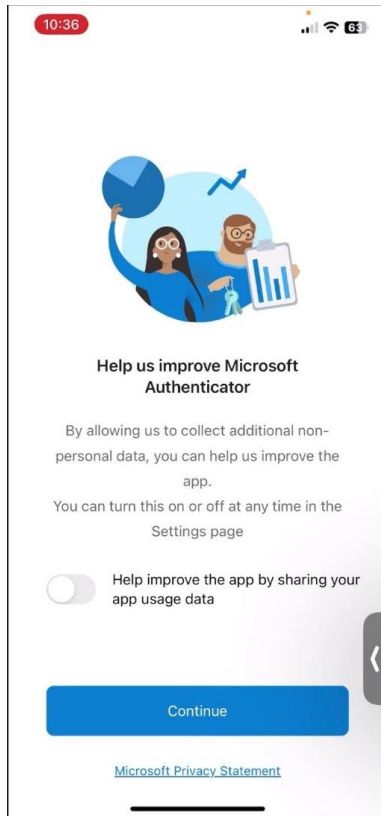

12. Click **Continue**

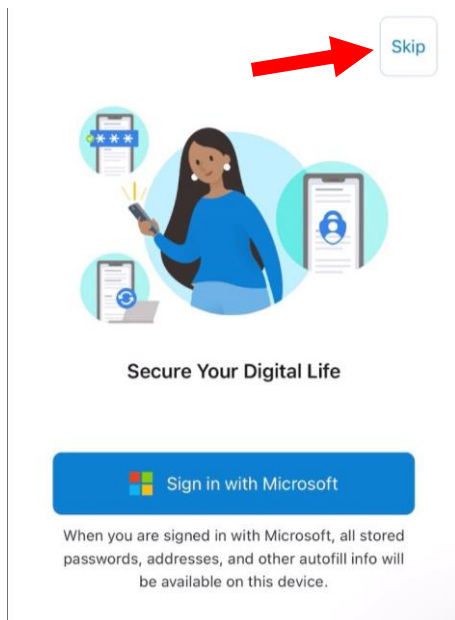

13. Click the **Skip** button in the upper right hand corner



Ready to add your first account?

Any Microsoft account or other type of account you add will appear here.

14. Locate the **+** **(Plus)** symbol in the upper right and click on it

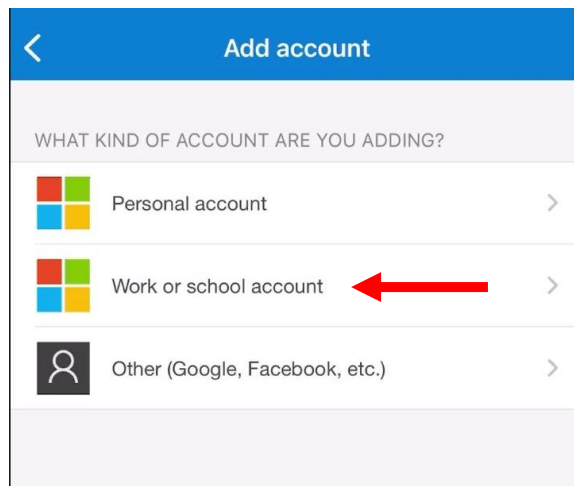

15. Now select **Work or School account**

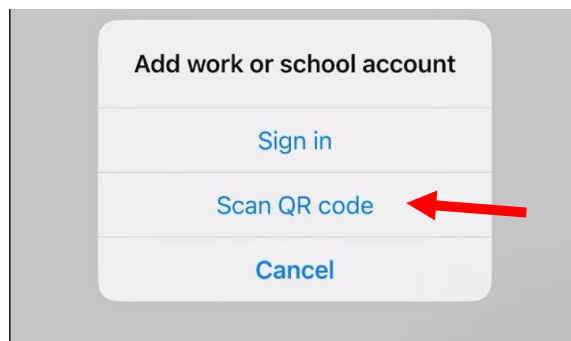

16. Select **Scan QR code**

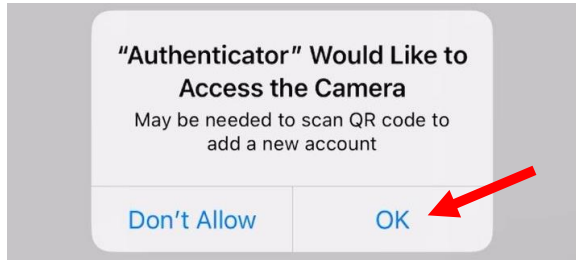

17. Press **Ok** button to allow Authenticator permission to use the device camera

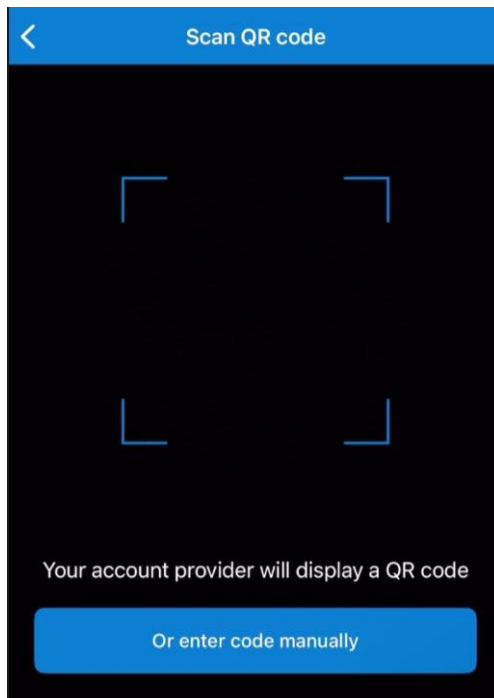

18. The mobile device camera should be ready to scan the QR code on the computer screen

19. Go back to your **computer** screen

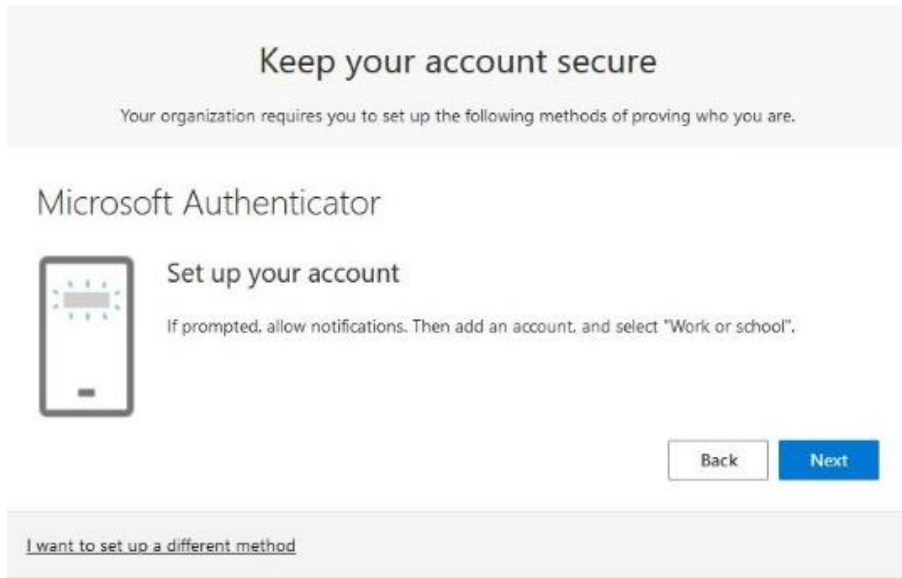

20. Click **Next**

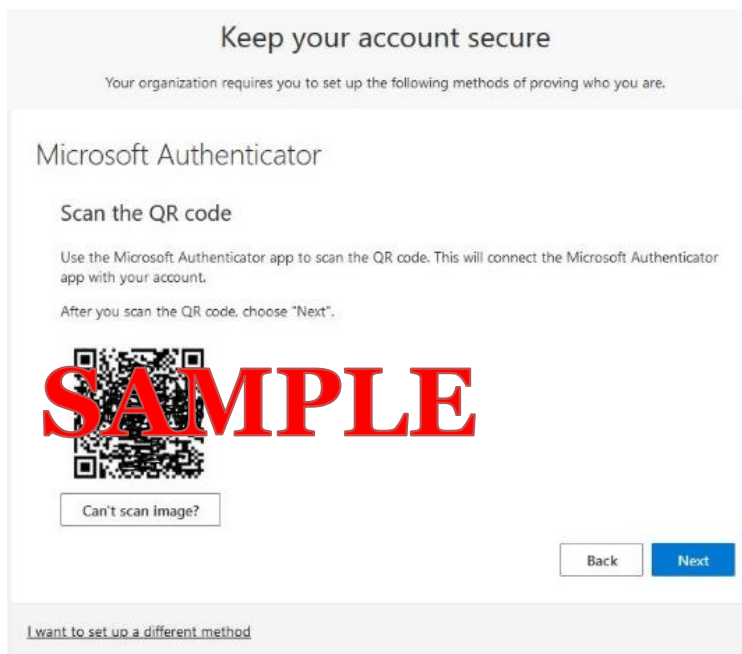

21. Now point your mobile device's camera at the QR code on your computer screen like shown above. Each QR code is unique to the person setting this up.

NOTE: If you receive a timeout error, please hit the Back button once. Then hit Next to get to the QR Code to show on the screen. Go back to step 20.

If you receive a QR code already used message in the app, hit cancel and try again. If you are still having issues, close the browser and start over.

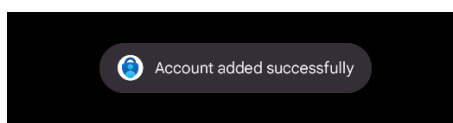

22. On your mobile device a message might flash by and say Account added successfully. (The messages flashes by very quickly so don't be alarmed if you do not see this)

23. Now back on your **computer** screen with the QR code above, click **Next**

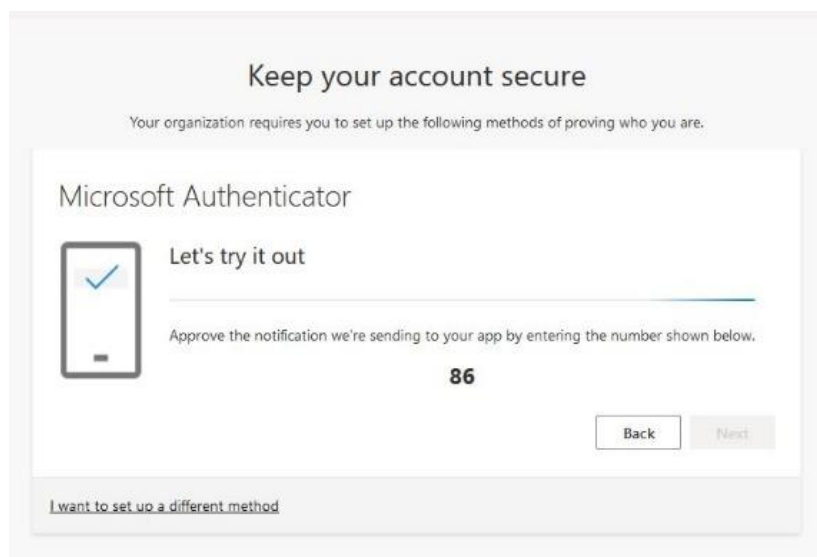

24. Microsoft will now send you a test number match notification to your mobile device

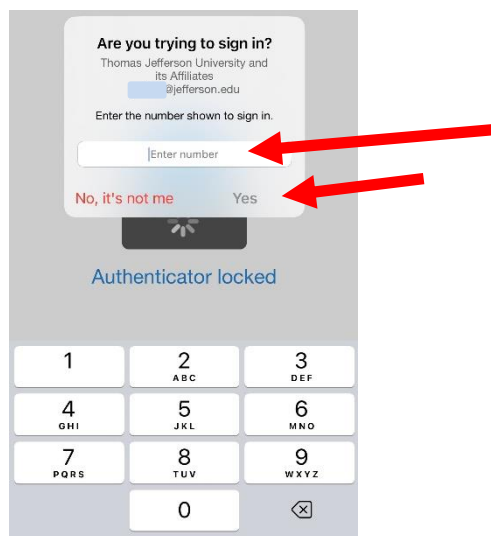

25. Go to your **mobile** device and find the notification and type in the number shown on the screen, in my example above, the number is 86. Your number will be unique to you and different each time. Note: If you don't see the notification, close Microsoft Authenticator app and reopen the app and it should appear. If you still don't see it, wait some time and it will time out and ask to send it again.

26. After entering the unique number, push **YES** (second **arrow** in above photo)

27. Then it might say “Notification Approved”

28. Go back to the **computer**, your screen will look like this below

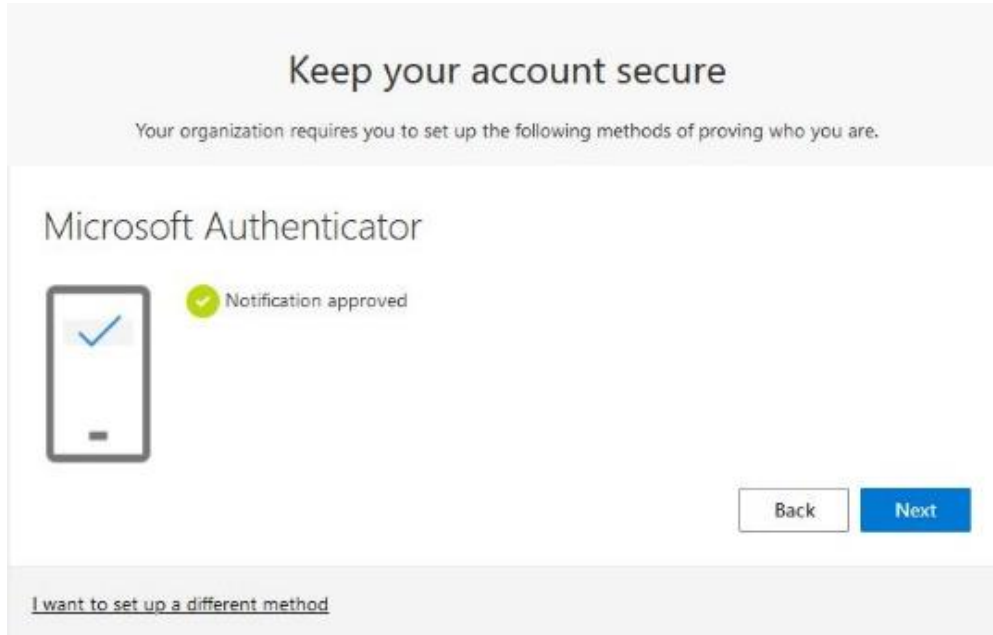

29. Click **Next**

30. You should see a Success! message appear

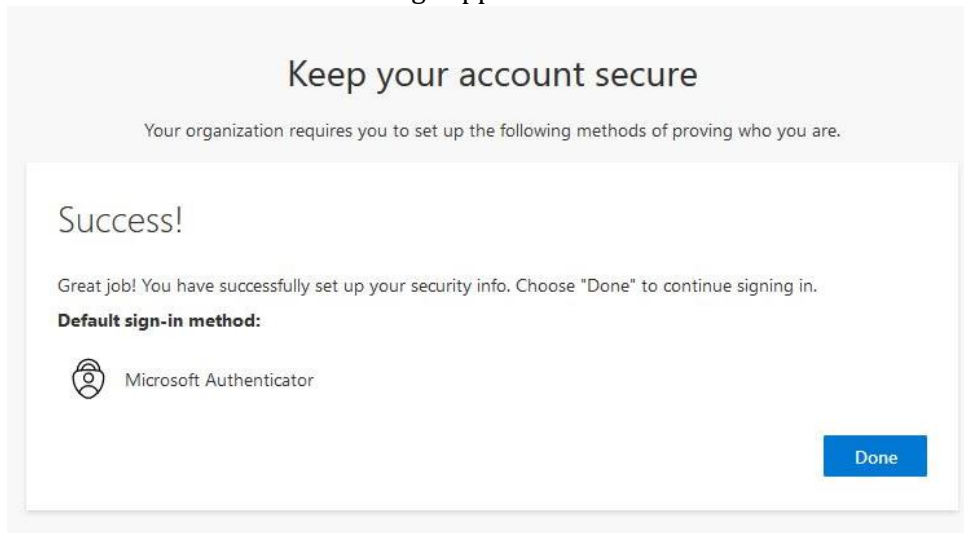

31. Click **Done**

32. It will finish signing you in. NOTE: If the session timed out, please enter your password again. If that doesn't work close the browser and try logging in again.

33. You have completed setting up Microsoft Authenticator App.

How to Set Up Microsoft Authenticator when on Campus

1. Go to <https://mysignins.microsoft.com/security-info> to login.
2. You will be prompted to Sign in.
 - a. Enter your email in the format abc123@jefferson.edu or abc123@Jeffersonhealthplans.com or abc123@students.jefferson.edu

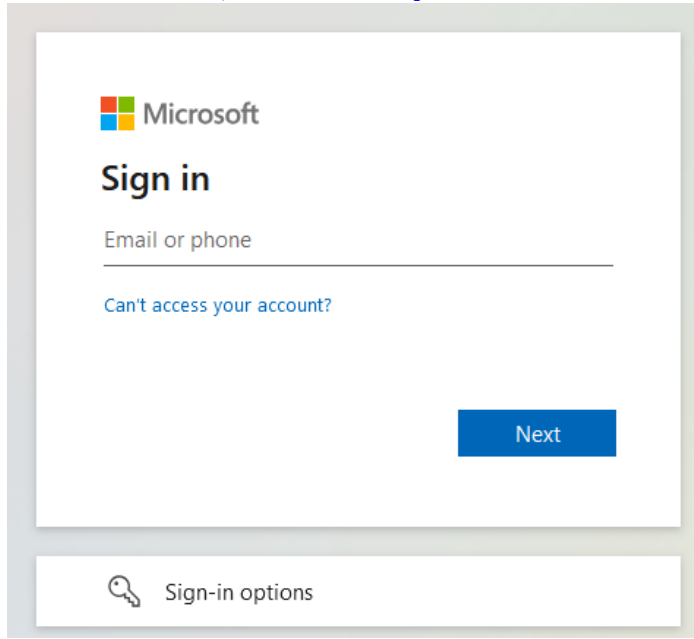
A screenshot of the Microsoft sign-in page. At the top is the Microsoft logo. Below it is the text "Sign in". There is a text input field labeled "Email or phone". Below the input field is a link that says "Can't access your account?". At the bottom right is a blue button labeled "Next". At the bottom left is a key icon and the text "Sign-in options".

3. Click **Next**

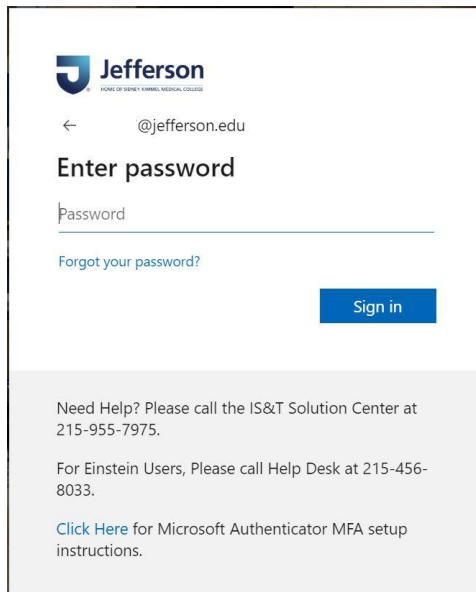
A screenshot of the Jefferson University login page. At the top is the Jefferson logo and the text "Jefferson". Below it is a back arrow and the text "@jefferson.edu". The main heading is "Enter password". There is a text input field labeled "Password". Below the input field is a link that says "Forgot your password?". At the bottom right is a blue button labeled "Sign in". At the bottom, there is a section with contact information: "Need Help? Please call the IS&T Solution Center at 215-955-7975." and "For Einstein Users, Please call Help Desk at 215-456-8033." Below this is a link that says "Click Here for Microsoft Authenticator MFA setup instructions."

4. Enter your password
5. Click **Sign in**

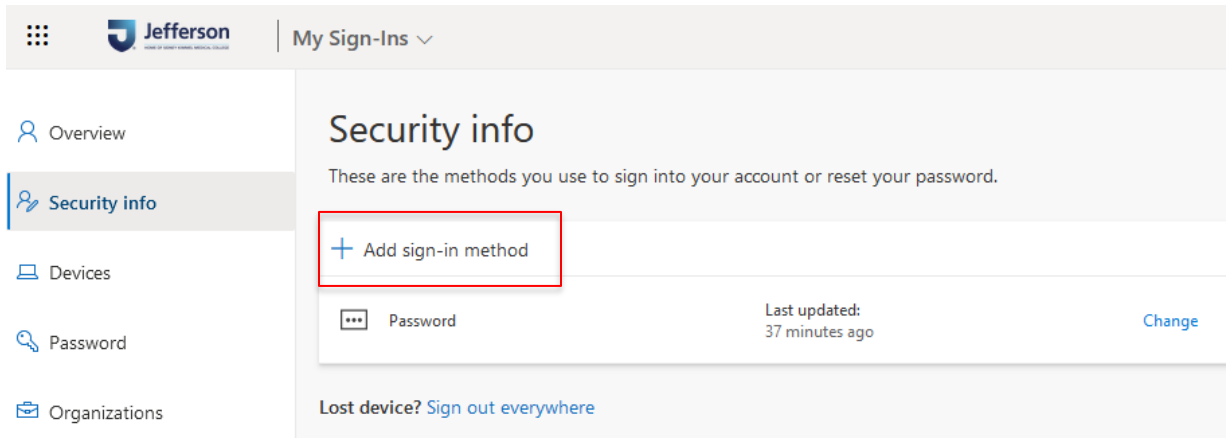

6. Click Add sign-in method

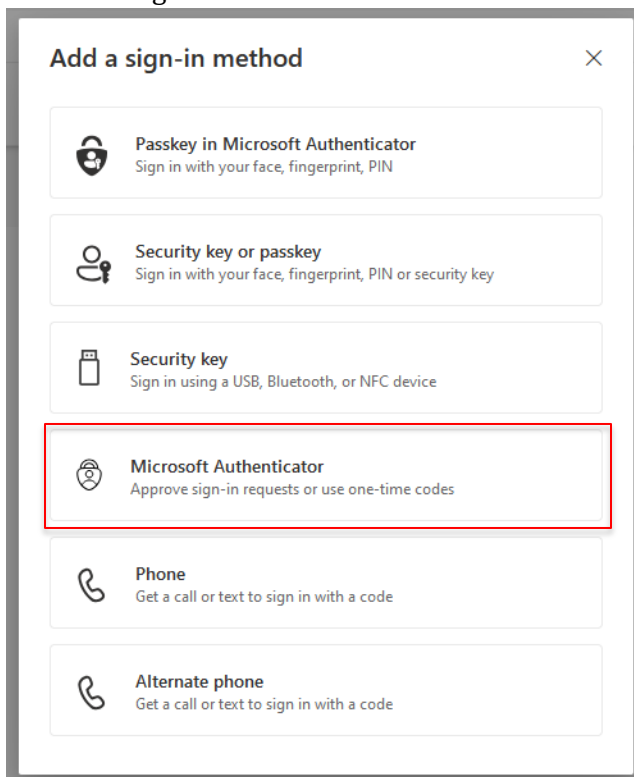

7. Click **Microsoft Authenticator**

8. You should have the **Microsoft Authenticator** app installed on your device. If not, please follow the prompts on the computer screen (see arrow below) or please see [How to install Microsoft Authenticator](#) or if you have a Jefferson issued Mobile Device [How to install Microsoft Authenticator from Jefferson App Store](#)

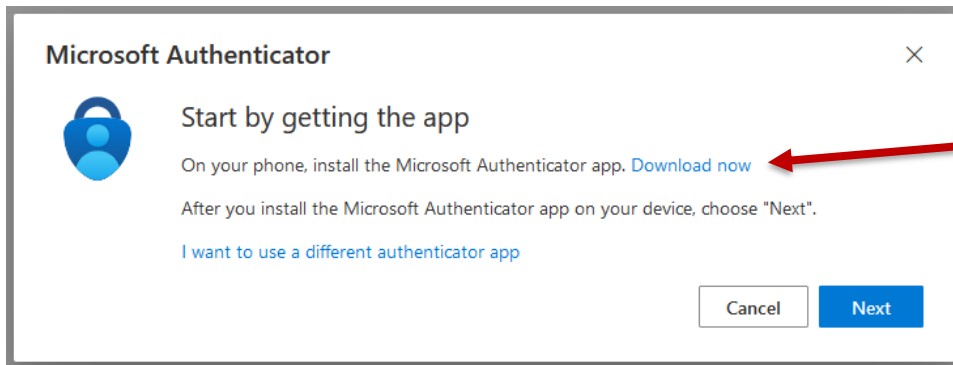

You can find more information about Microsoft Authenticator and where to download the app with this link.

<https://www.microsoft.com/en-us/security/mobile-authenticator-app?rtc=1>

9. Once you have the app installed click **Next**

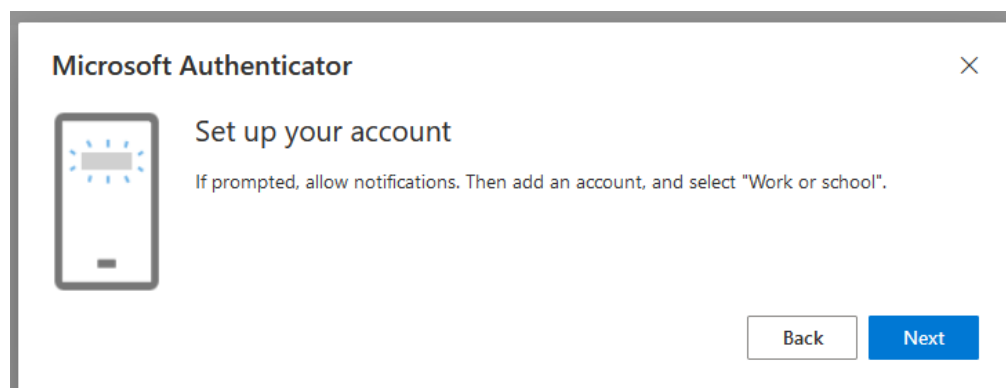

10. Now go to your **mobile device** and open the **Microsoft Authenticator** app. If you have already used Microsoft Authenticator with another company or account, skip to step 14.



11. Click **Accept**

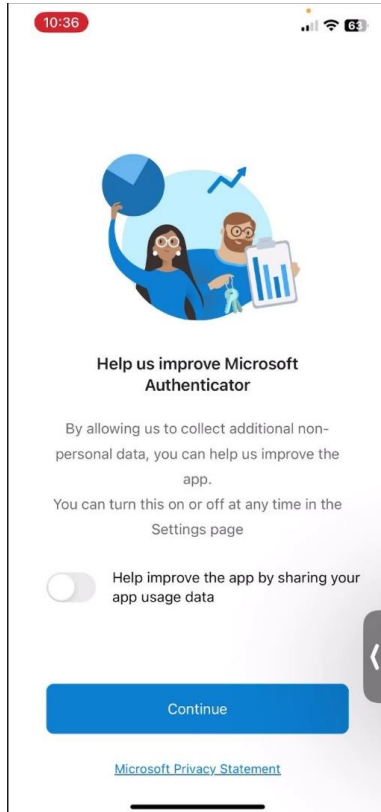

12. Click **Continue**

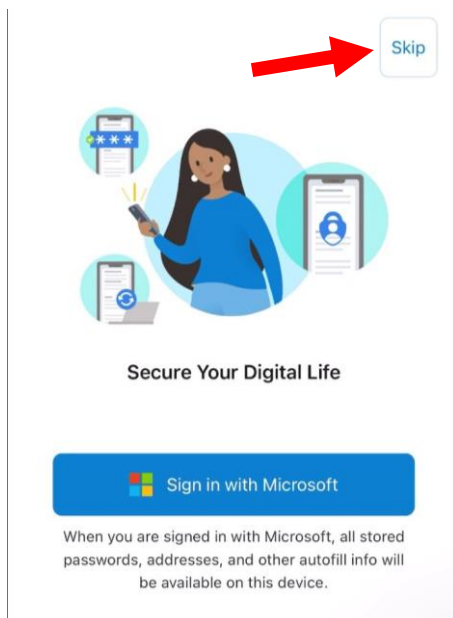

13. Click the **Skip** button in the upper right hand corner



Ready to add your first account?

Any Microsoft account or other type of account you add will appear here.

14. Locate the **+** (**Plus**) symbol in the upper right and click on it

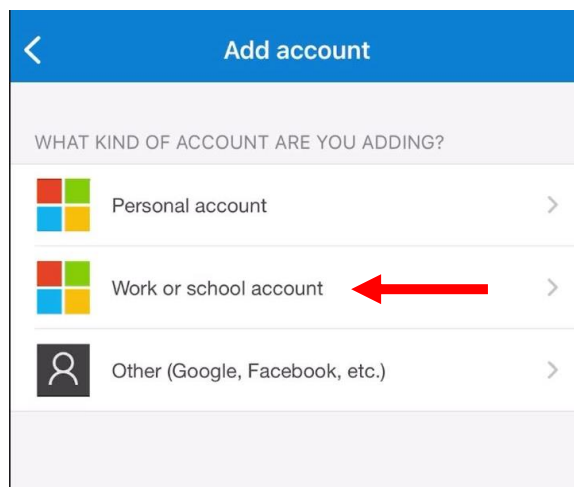

15. Now select **Work or School account**

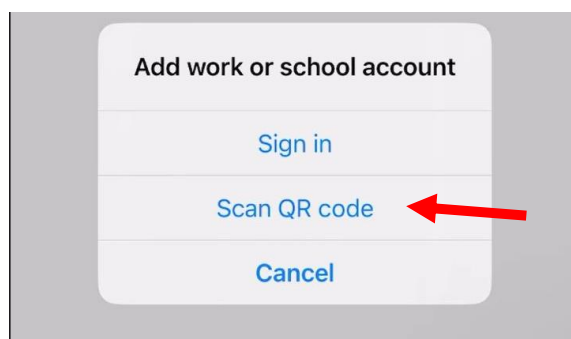

16. Select **Scan QR code**

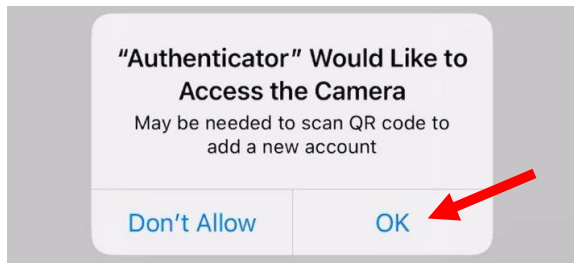

17. Press **Ok** button to allow Authenticator permission to use the device camera

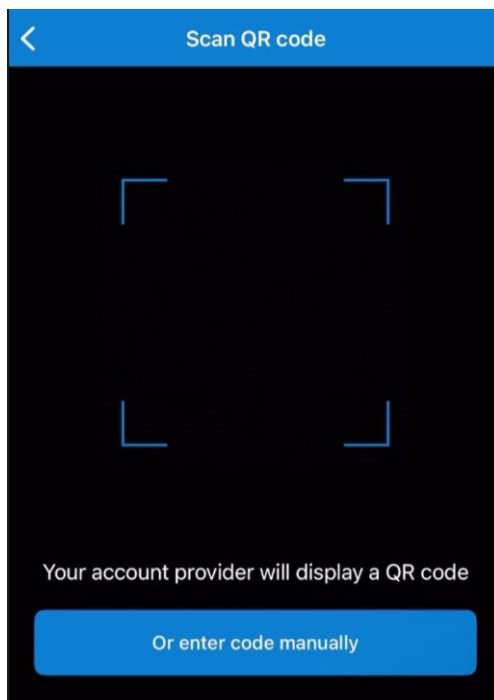

18. The mobile device camera should be ready to scan the QR code on the computer screen

19. Go back to your **computer** screen

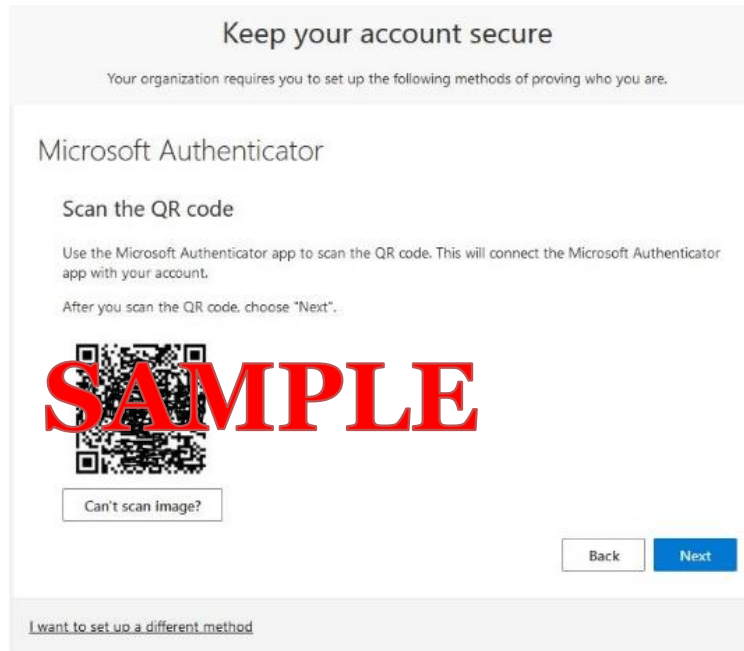

20. Now point your mobile device's camera at the QR code on your computer screen like shown above. Each QR code is unique to the person setting this up.

NOTE: If you receive a timeout error, please hit the Back button once. Then hit Next to get to the QR Code to show on the screen. Go back to step 19.

If you receive a QR code already used message in the app, hit cancel and try again. If you are still having issues, close the browser and start over.

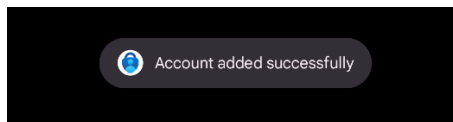

21. On your mobile device a message might flash by and say Account added successfully. (The messages flashes by very quickly so don't be alarmed if you do not see this)

22. Now back on your **computer** screen with the QR code above, click **Next**



23. Microsoft will now send you a test number match notification to your mobile device

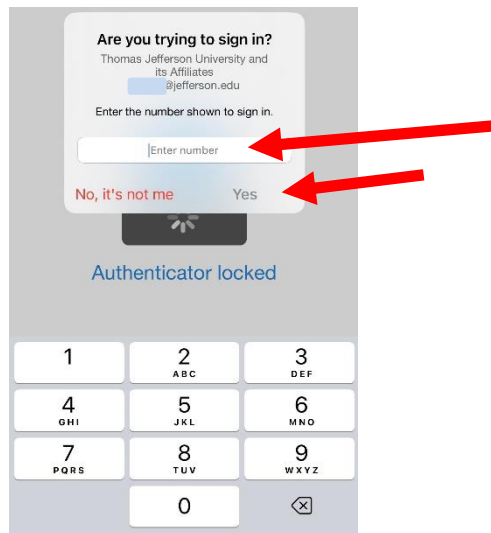

24. Go to your **mobile** device and find the notification and type in the number shown on the screen, in my example above, the number is 86. Your number will be unique to you and different each time. Note: If you don't see the notification, close Microsoft Authenticator app and reopen the app and it should appear. If you still don't see it, wait some time and it will time out and ask to send it again.

25. After entering the unique number, push **YES** (second **arrow** in above photo)

26. Then it might say "Notification Approved"

27. Go back to the **computer**, your screen will look like this below



28. Click **Next**

29. You should see a Success! message appear

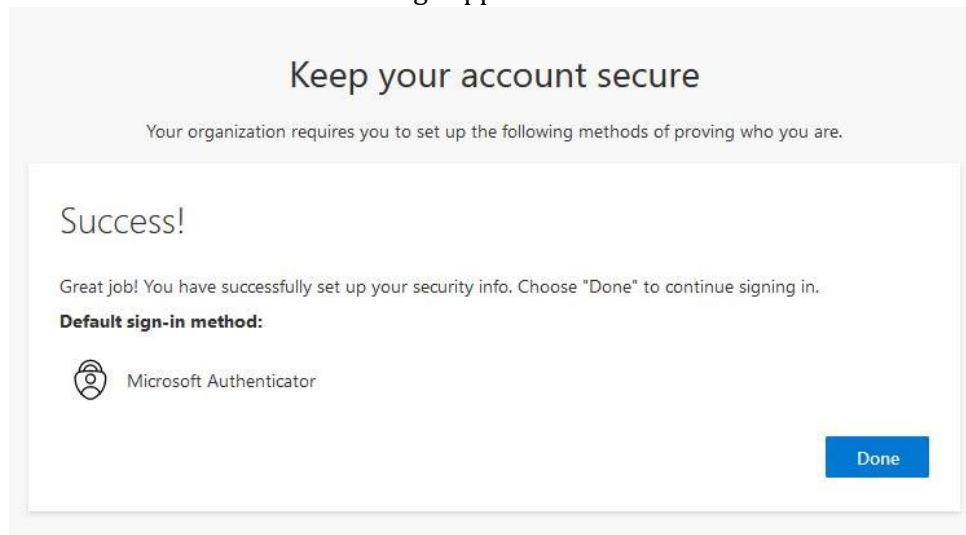

30. Click **Done**

31. It will finish signing you in. NOTE: If the session timed out, please enter your password again. If that doesn't work close the browser and try logging in again.

32. You have completed setting up Microsoft Authenticator App.

Appendix - Trouble Shooting Tips

TIP #1

If you see a screen that says **“We didn’t hear from you”**

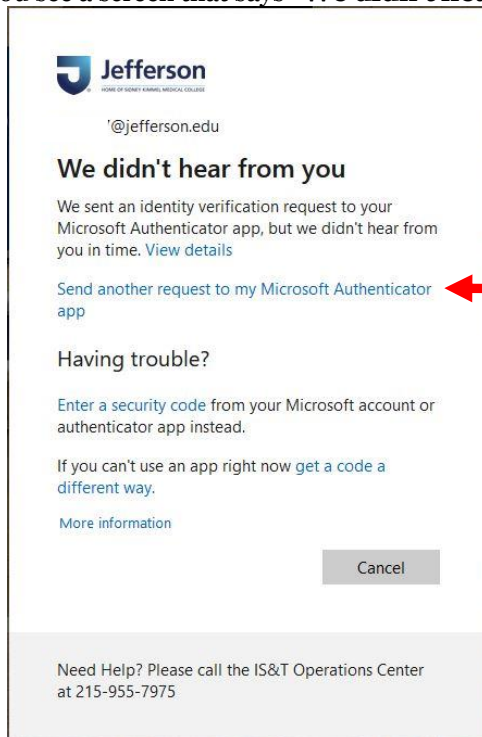

Click **“Send another request to my Microsoft Authenticator app”** and it will give you a new number to enter into the Microsoft Authenticator app prompt on your mobile device.

How to add Phone call or SMS if unable to install Microsoft Authenticator

1. Follow steps [1-11](#) above until it asks you to install Microsoft Authenticator

Keep your account secure

Your organization requires you to set up the following methods of proving who you are.

Microsoft Authenticator



Start by getting the app

On your phone, install the Microsoft Authenticator app. [Download now](#)

After you install the Microsoft Authenticator app on your device, choose "Next".

[I want to use a different authenticator app](#)

[Next](#)

[I want to set up a different method](#)

2. Click on **"I want to set up a different method"**

Choose a different method

Which method would you like to use?

Choose a method

Cancel Confirm

3. Click the drop down menu and select **Phone**

Choose a different method

Which method would you like to use?

Phone

Cancel Confirm

4. Click **Confirm**

Keep your account secure

Your organization requires you to set up the following methods of proving who you are.

Phone

You can prove who you are by answering a call on your phone or receiving a code on your phone.

What phone number would you like to use?

United States (+1) ▼

Enter phone number

A ←

B → ☒ Receive a code

C → ☐ Call me

Message and data rates may apply. Choosing Next means that you agree to the [Terms of service](#) and [Privacy and cookies statement](#).

Next

[I want to set up a different method](#)

5. Enter your phone number in section A
Option B **Receive a code** is to receive an SMS text MFA code
Option C **Call me** is to receive a phone call to accept MFA
6. After entering A and choosing B or C click **Next**
7. If you chose option B, it will send you an SMS text message. Go to Step 9
8. If you chose option C, you will receive a phone call. Follow the voice instructions
9. Enter the SMS code in the box

Keep your account secure

Your organization requires you to set up the following methods of proving who you are.

Phone

We just sent a 6 digit code to +1 . Enter the code below.

Sample

Resend code

Back Next

[I want to set up a different method](#)

10. Click **Next**

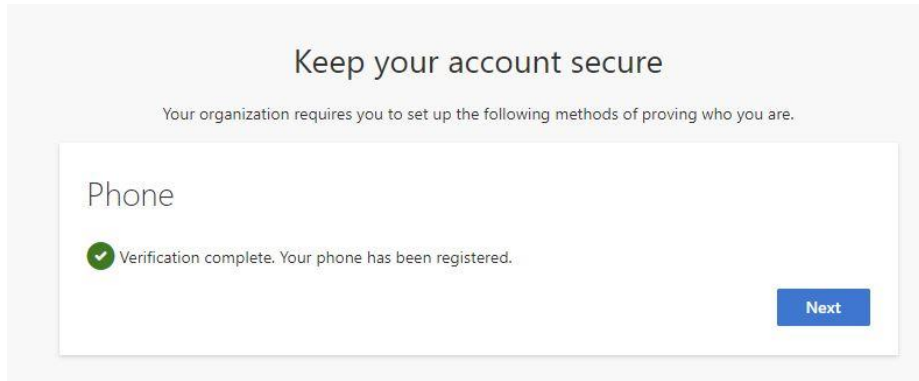

11. Click **Next**

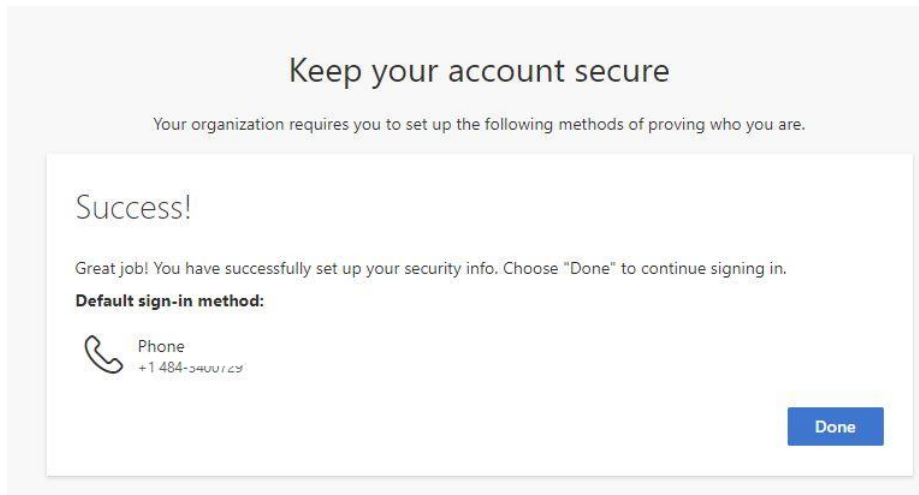

12. Success! And click **Done**

13. You have completed the setup

How to add additional MFA methods (Phone Extension Example)

1. Go to login.microsoft.com
2. Login with your Jefferson account (campuskey@jefferson.edu)

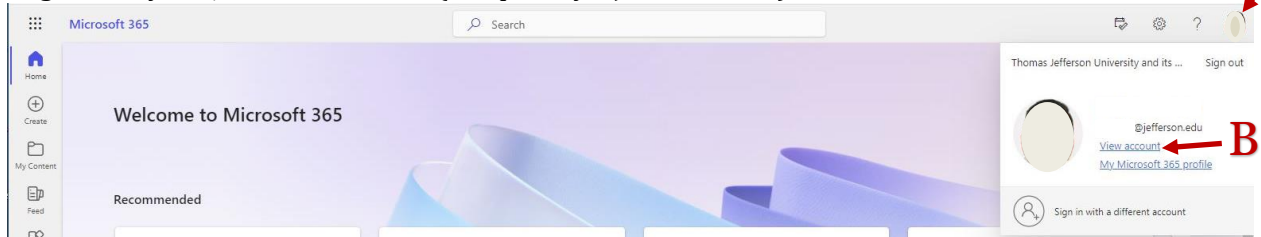

3. Click your face in the upper right hand corner (A) (Please note: that it might be greyed out if your photo hasn't uploaded yet)
4. Then click **View Account** (B)

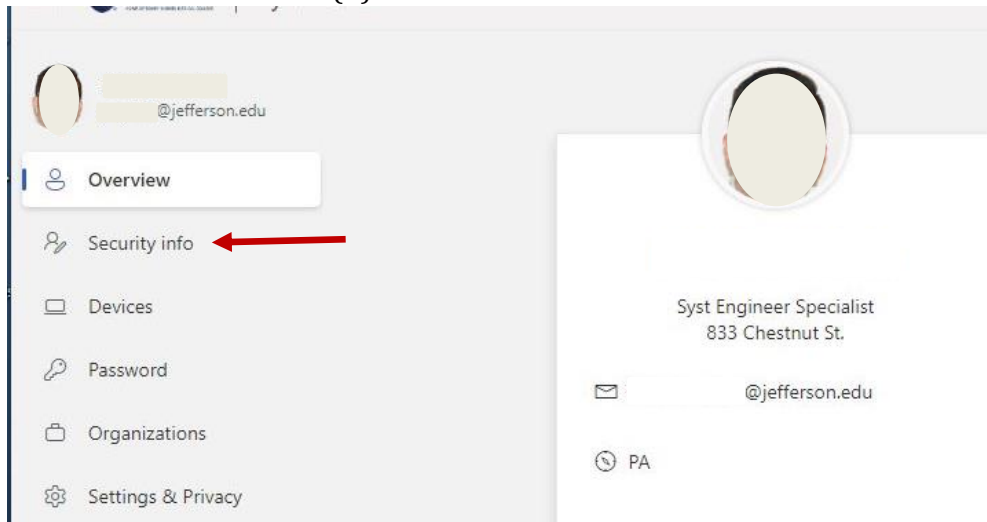

5. Click **Security info**

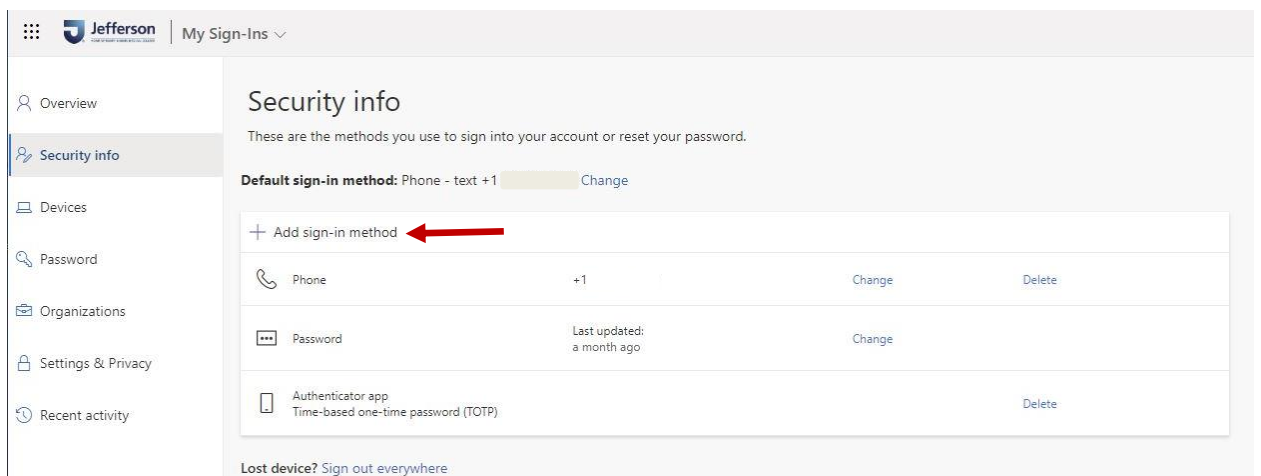

6. Click **+ Add sign-in Method**

Add a method ×

Which method would you like to add?

Choose a method ▼

7. Choose **Office Phone** in the **Choose a method** drop down

Add a method ×

Which method would you like to add?

Office phone ▼

8. Click **Add**

Phone ×

You can prove who you are by answering a call on your phone.

What phone number would you like to use?

United States (+1) ▼

Extension:

☒ Call me

Message and data rates may apply. Choosing Next means that you agree to the [Terms of service](#) and [Privacy and cookies statement](#).

9. Enter the phone number and extension and hit **Next**



10. Microsoft will call the number you entered to verify it works. Answer the phone call and follow the voice prompts. (If you do not receive a phone call, unfortunately this option will not work with your phone system and you will need to add a direct line as in the section "How to add Phone call or SMS if unable to install Microsoft Authenticator" in this document above.)

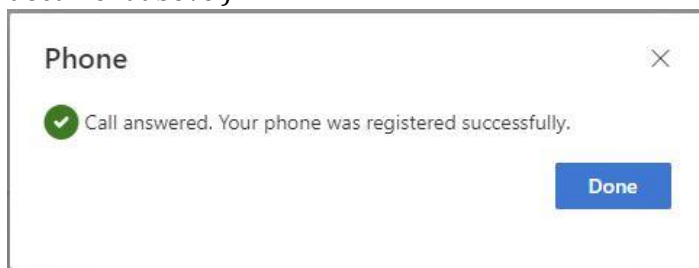

11. Click **Done**
12. You have completed the setup

How to install Microsoft Authenticator from Jefferson App Store

1. Open **Jefferson Apps** from your Jefferson issued Mobile Device (Your mobile screen setup might look a little different)

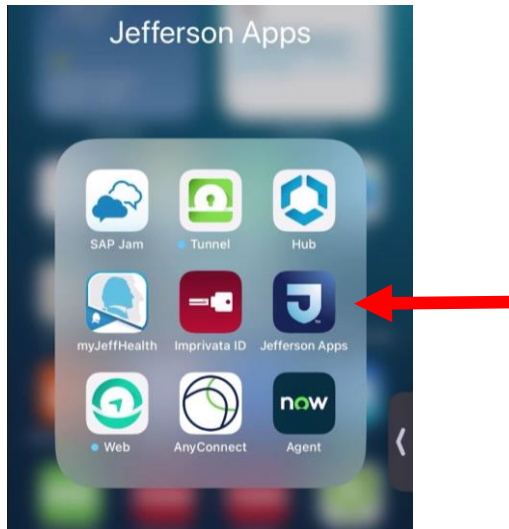

2. Locate or search for **Microsoft Authenticator**

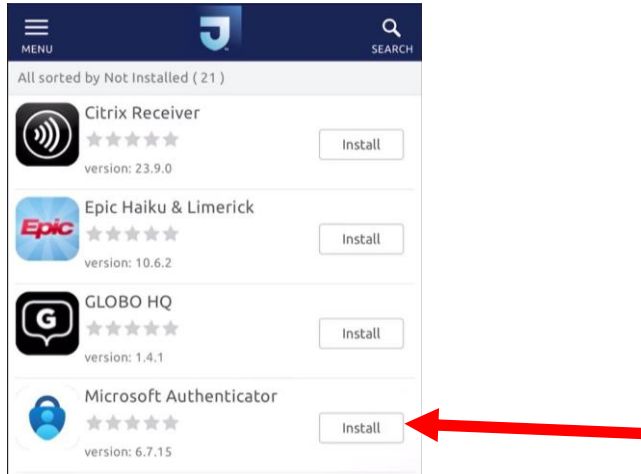

3. Press **Install**

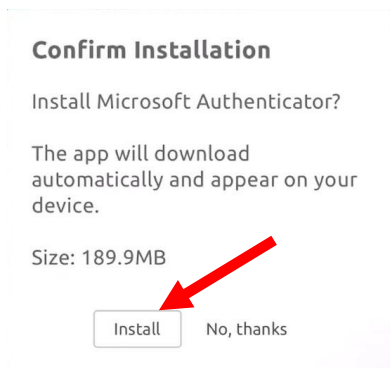

4. Press **Install** again on the confirm Installation Screen

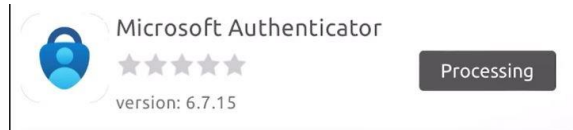

5. The app will show Processing and will finish installing

How to add a second phone to MS Authenticator

1. Go to login.microsoft.com from a computer
2. Login with your Jefferson account (**campuskey@jefferson.edu**)

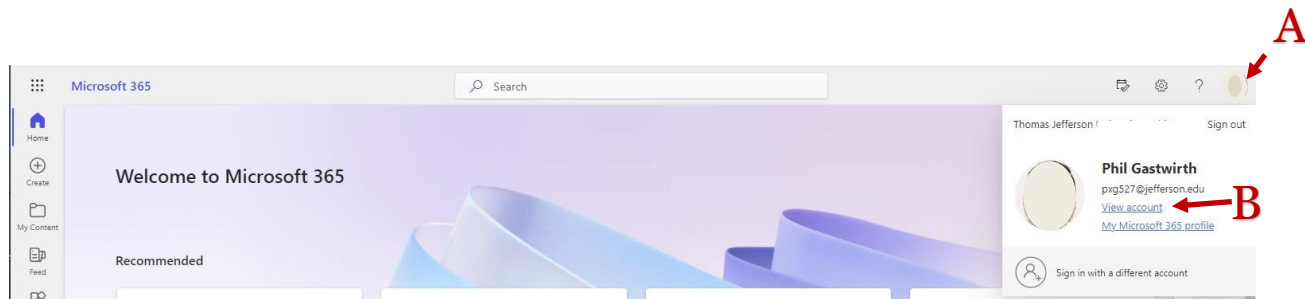

3. Click your face in the upper right hand corner (A) (Please note: that it might be greyed out if your photo hasn't uploaded yet)
4. Then click **View Account** (B)

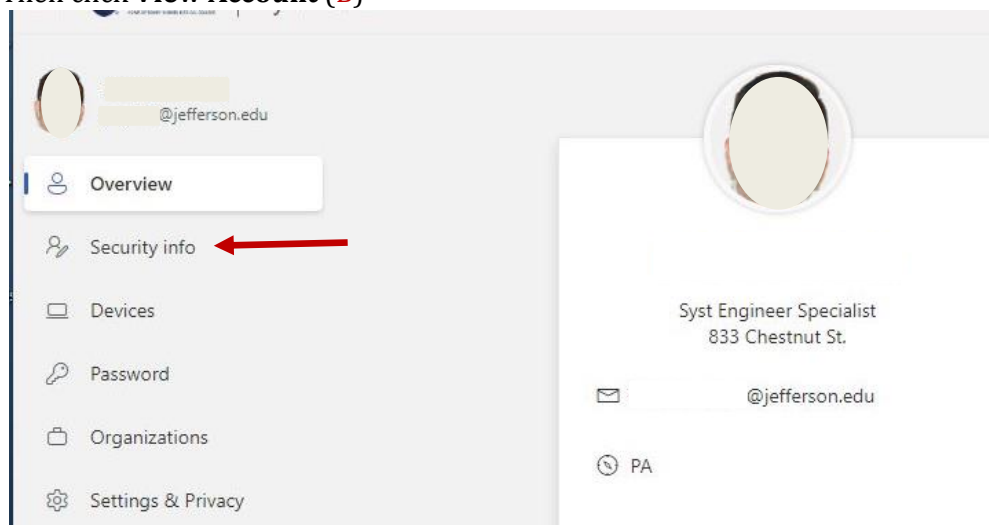

5. Click **Security info**

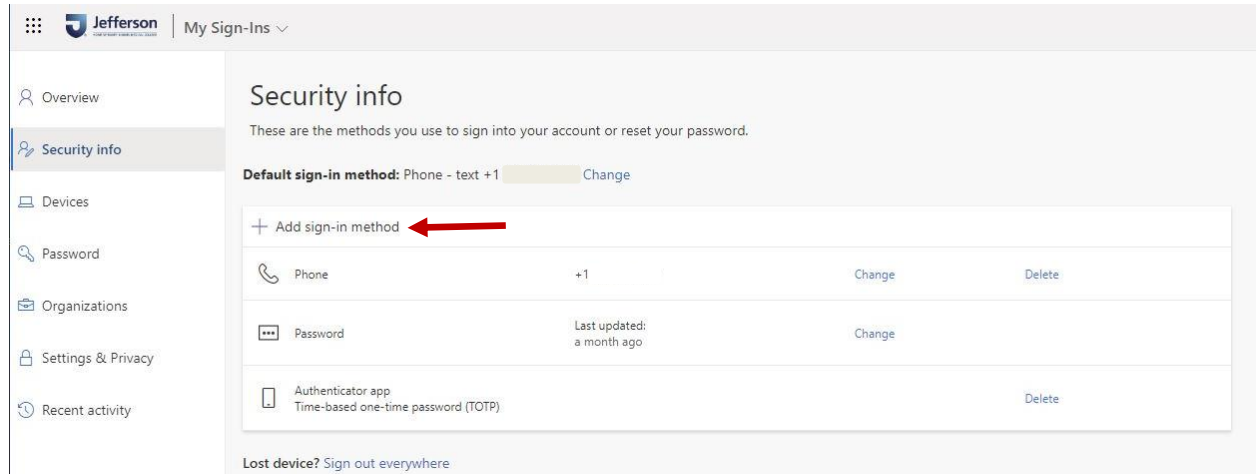

6. Click **+ Add sign-in Method**

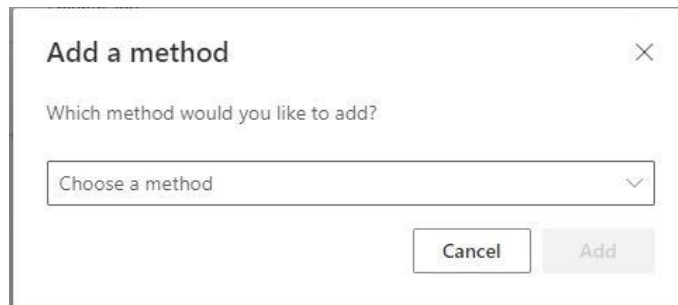

7. Click the drop down Choose a method

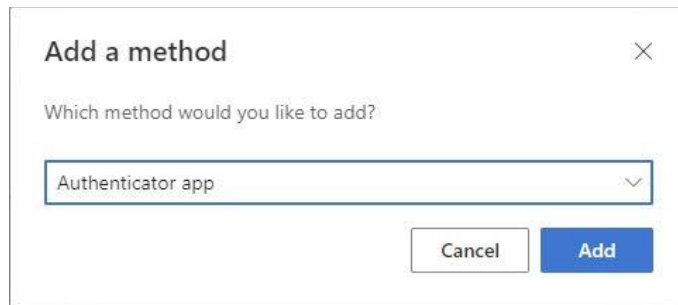

8. Select **Authenticator App** and click **Add**

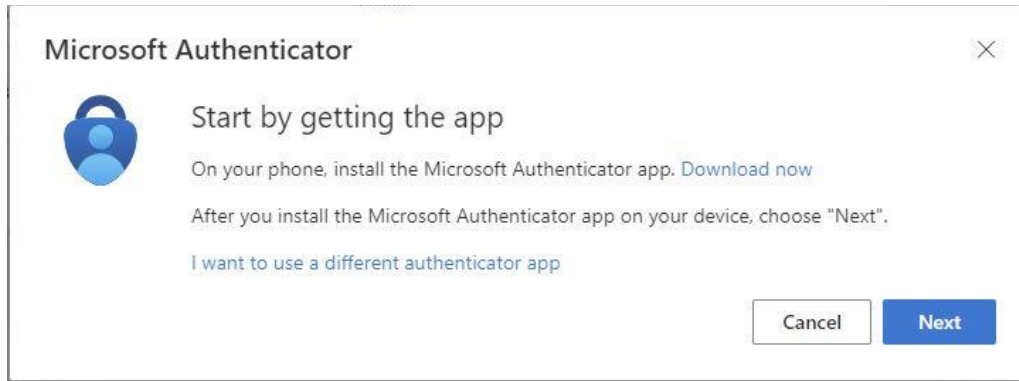

9. On your second phone make sure to download Microsoft Authenticator app. Please reference [here](#)
10. Click **Next** on your computer screen

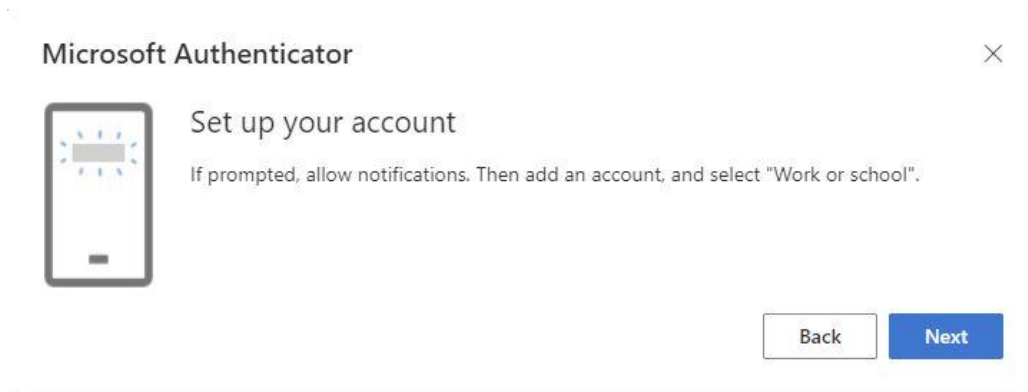

11. Click **Next**
12. Open the Microsoft Authenticator app on your secondary phone



Ready to add your first account?

Any Microsoft account or other type of account you add will appear here.

13. Locate the + (Plus) symbol in the upper right and click on it

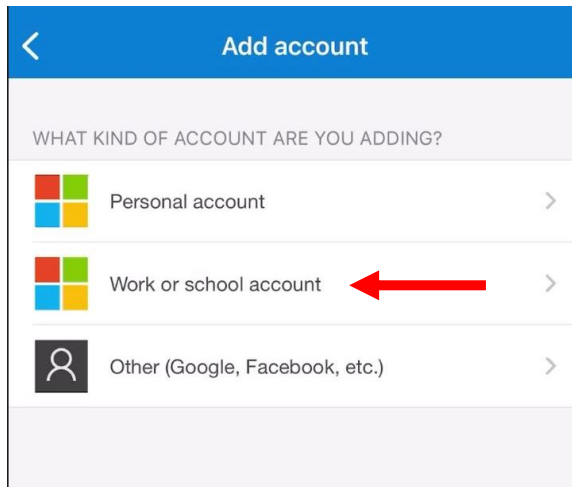

14. Now select **Work or School account**

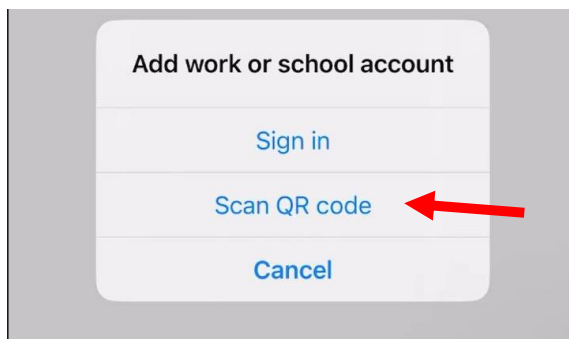

15. Select **Scan QR code**

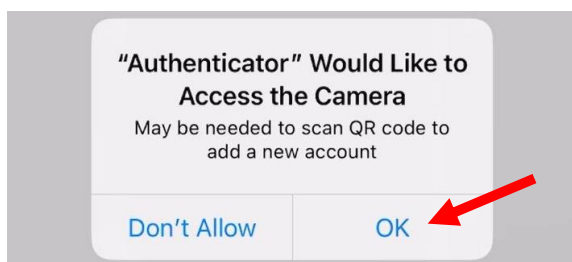

16. Press **Ok** button to allow Authenticator permission to use the devices camera

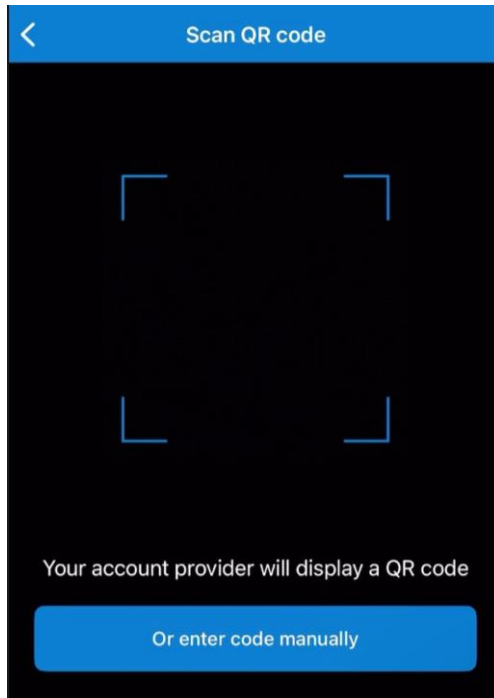

17. The mobile device camera should be ready to scan the QR code on the computer screen

18. Go back to your **computer** screen

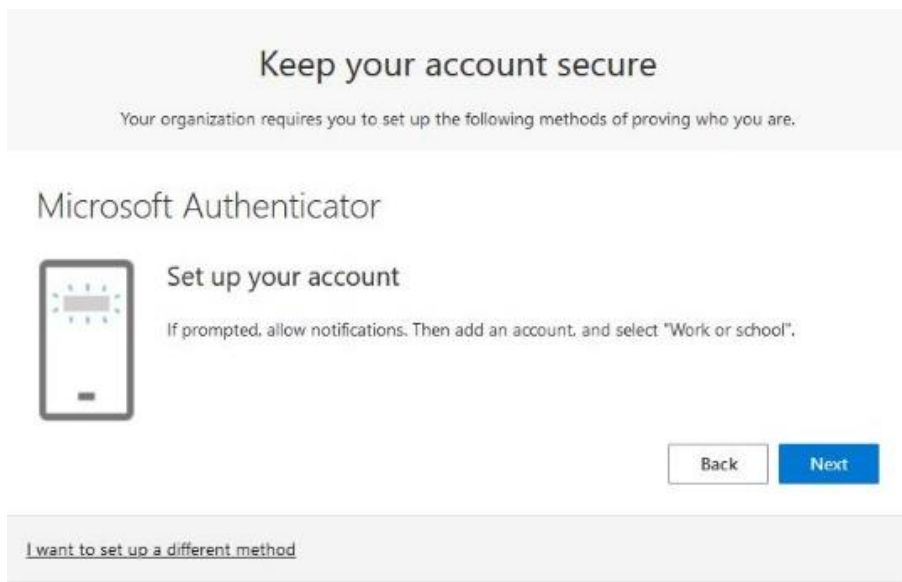

19. Click **Next**

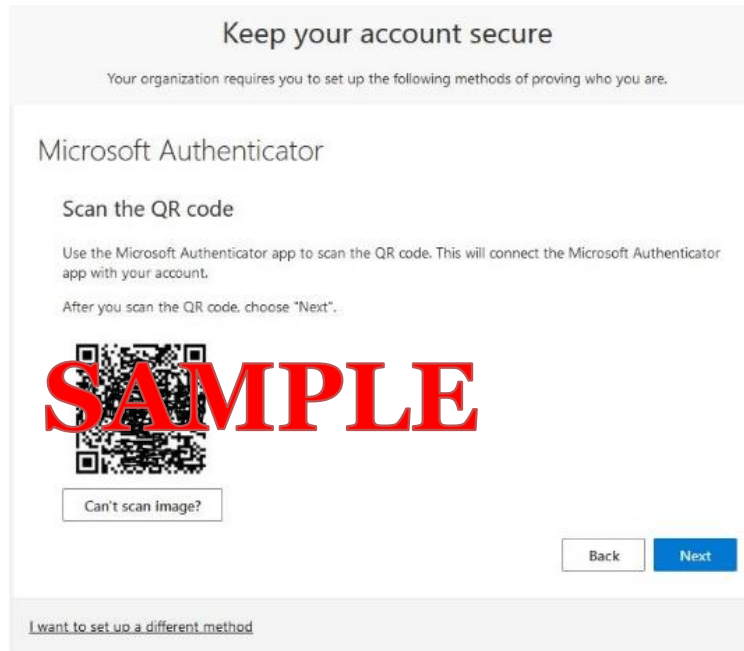

20. Now point your mobile device's camera at the QR code on your computer screen like shown above. Each QR code is unique to the person setting this up.

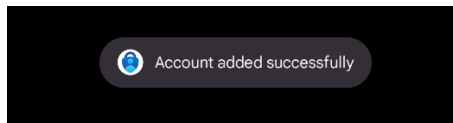

21. On your mobile device a message might flash by and say Account added successfully. (The messages flashes by very quickly so don't be alarmed if you do not see this)

22. Now back on your **computer** screen with the QR code above, click **Next**

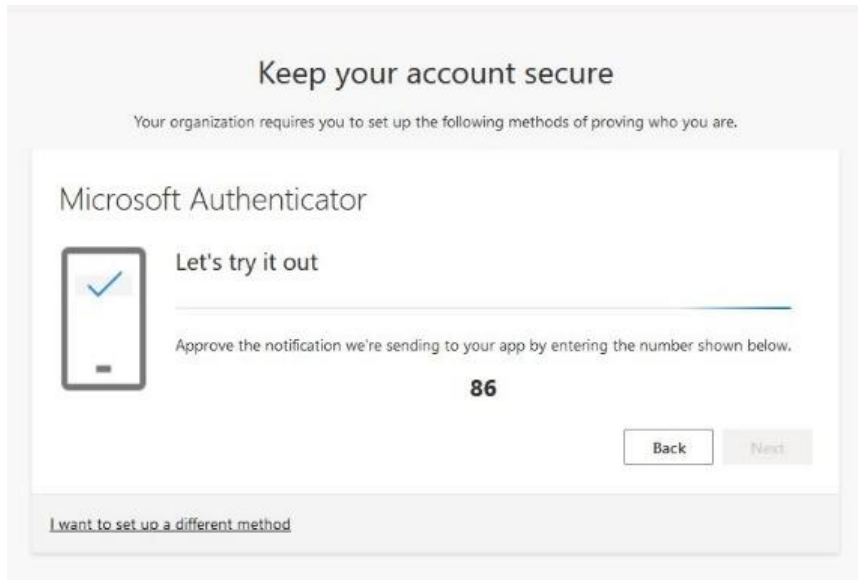

23. Microsoft will now send you a test number match notification to your mobile device

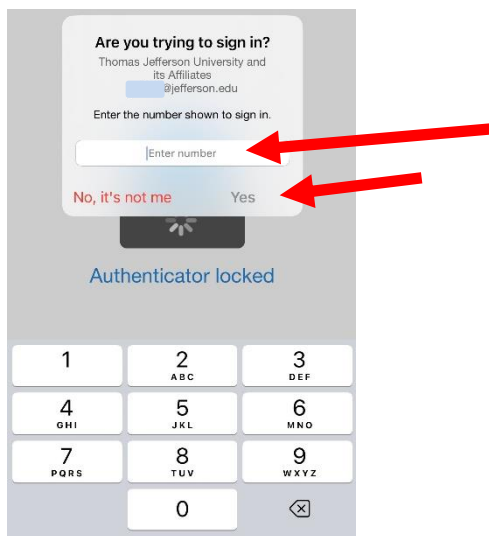

24. Go to your **mobile** device and find the notification and type in the number shown on the screen, in my example above, the number is 86. Your number will be unique to you and different each time. Note: If you don't see the notification, close Microsoft Authenticator app and reopen the app and it should appear. If you still don't see it, wait some time and it will time out and ask to send it again.

25. After entering the unique number, push **YES** (second **arrow** in above photo)

26. Then it might say "Notification Approved"

27. Go back to the **computer**, your screen will look like this below



28. Click **Next**

29. You have completed adding your secondary device

Phone/SMS Users - How to set up MS Authenticator MFA App for push notification

1. Go to <https://login.microsoft.com> from a computer
2. Login with your Jefferson account (**campuskey@jefferson.edu**)

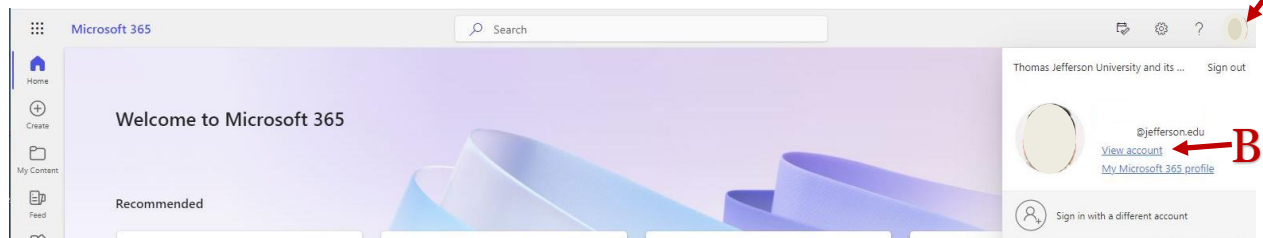

3. Click your face in the upper right hand corner (A) (Please note: that it might be greyed out if your photo hasn't uploaded yet)
4. Then click **View Account** (B)

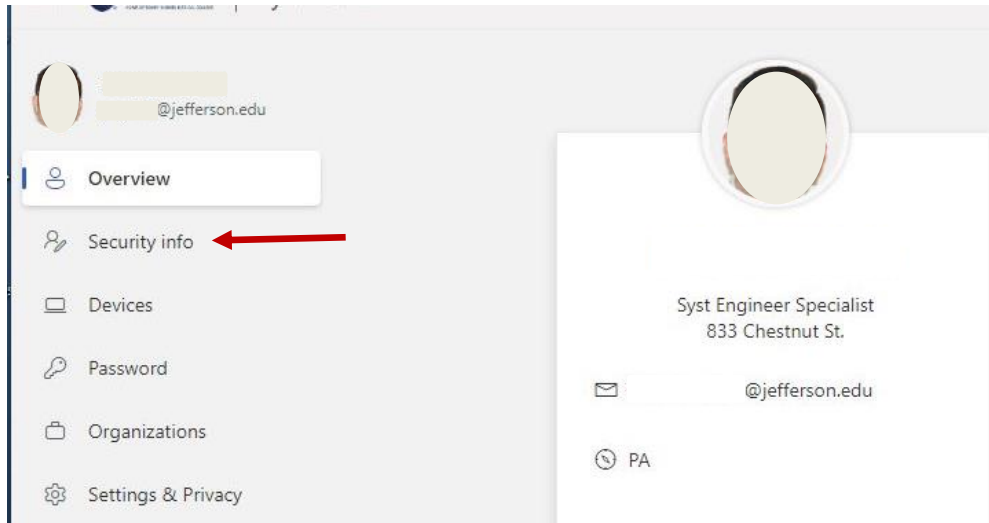

5. Click **Security info**

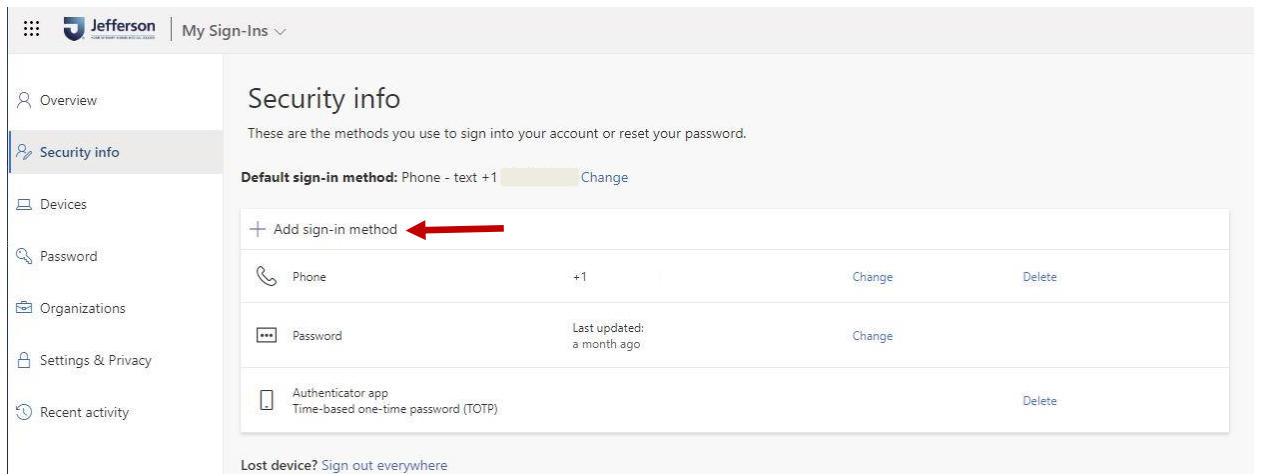

6. Click **+ Add sign-in Method**

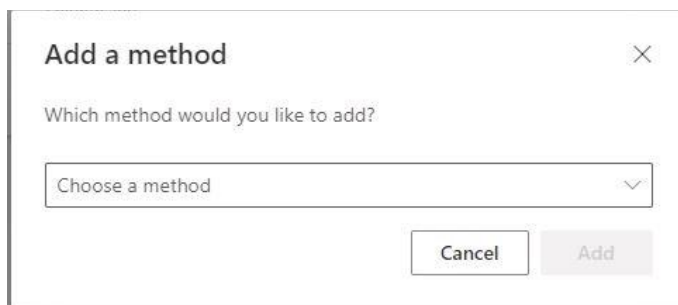

7. Click the drop down **Choose a method**

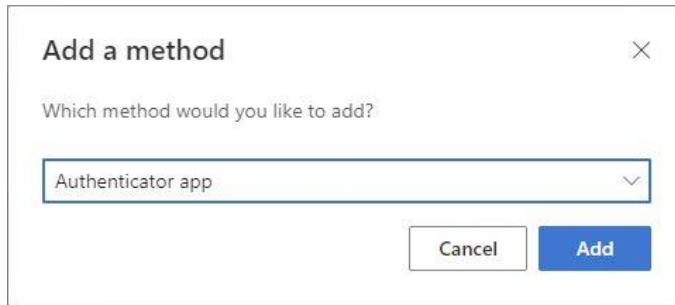

8. Select **Authenticator App** and click **Add**



9. On your phone make sure to download Microsoft Authenticator app. Please reference [here](#)

10. Click **Next** on your computer screen

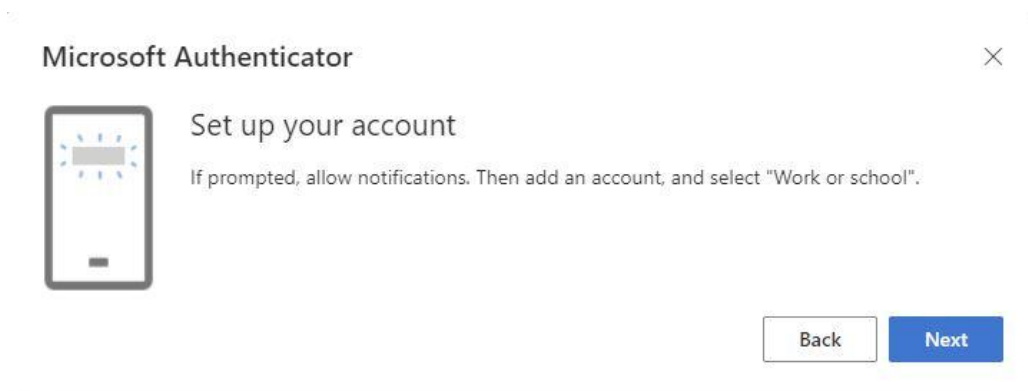

11. Click **Next**

12. Open the Microsoft Authenticator app on your phone



Ready to add your first account?

Any Microsoft account or other type of account you add will appear here.

13. Locate the + (Plus) symbol in the upper right and click on it

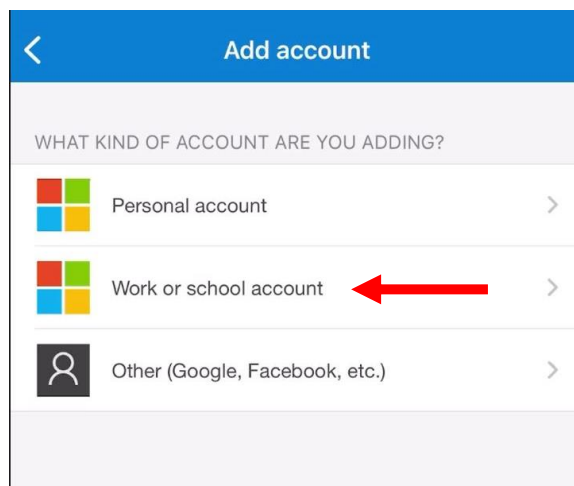

14. Now select **Work or School account**

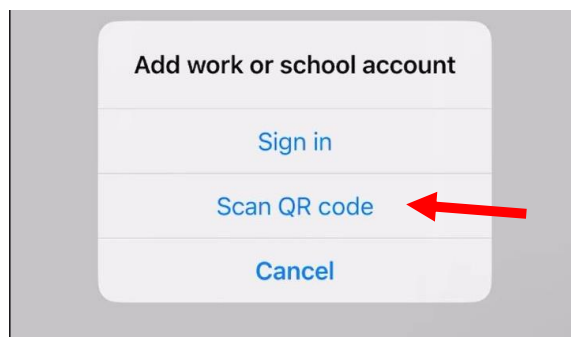

15. Select **Scan QR code**

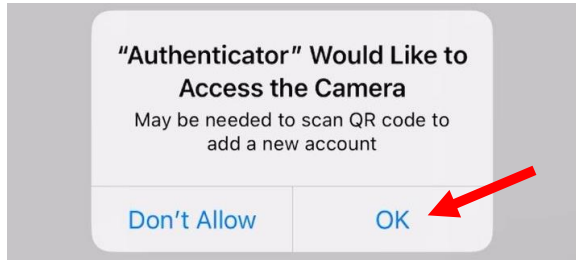

16. Press **Ok** button to allow Authenticator permission to use the devices camera

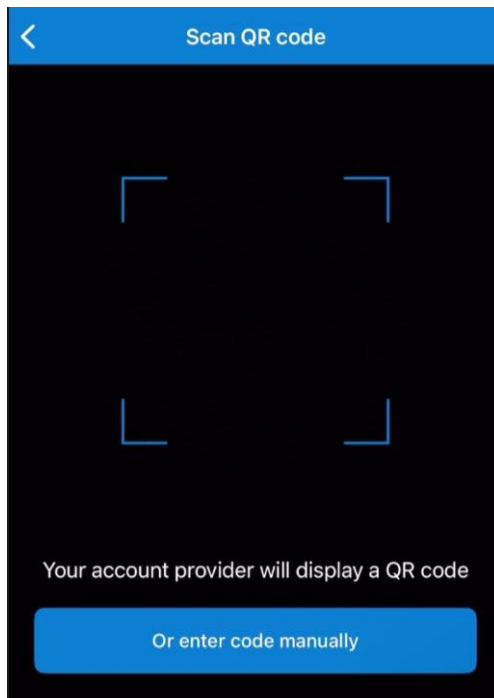

17. The mobile device camera should be ready to scan the QR code on the computer screen

18. Go back to your **computer** screen

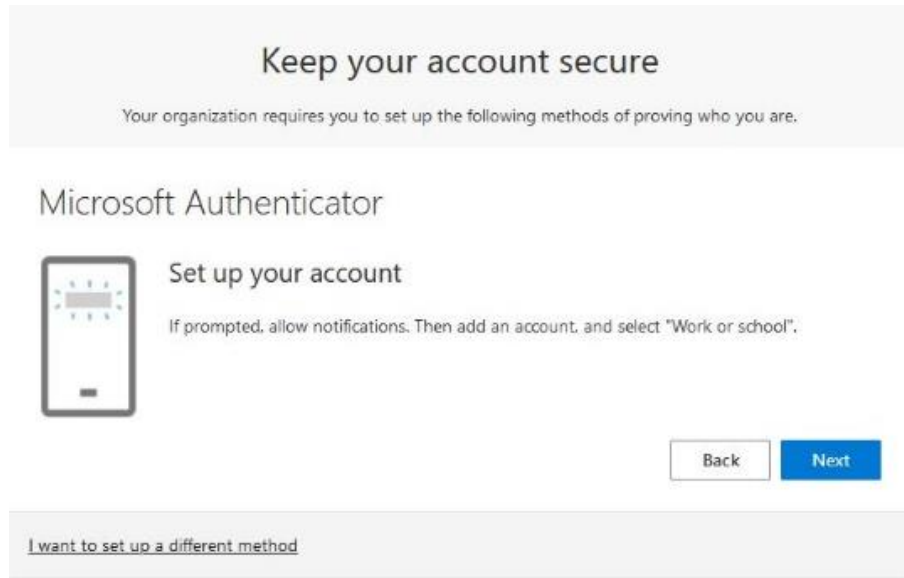

19. Click **Next**

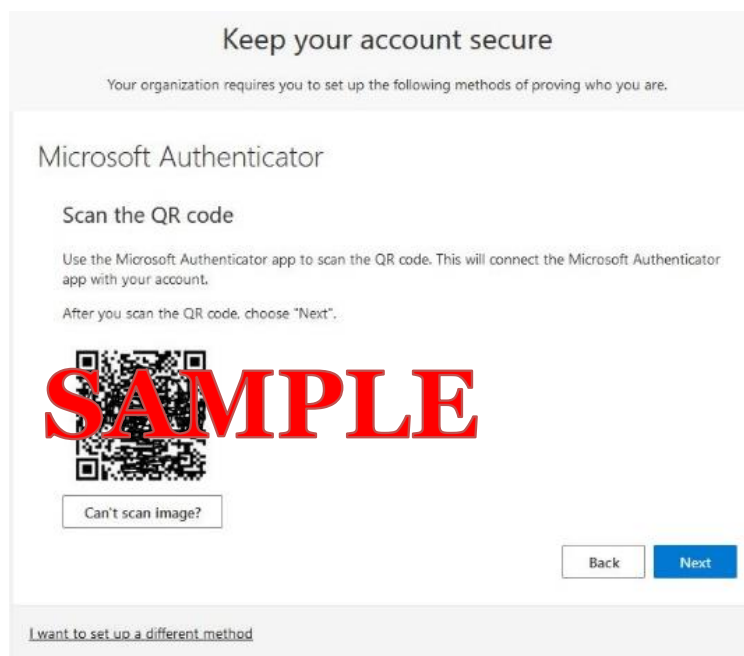

20. Now point your mobile device's camera at the QR code on your computer screen like shown above. Each QR code is unique to the person setting this up.

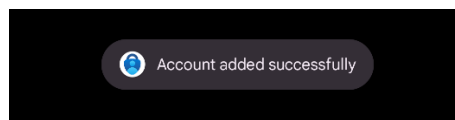

21. On your mobile device a message might flash by and say Account added successfully. (The messages flashes by very quickly so don't be alarmed if you do not see this)

22. Now back on your **computer** screen with the QR code above, click **Next**

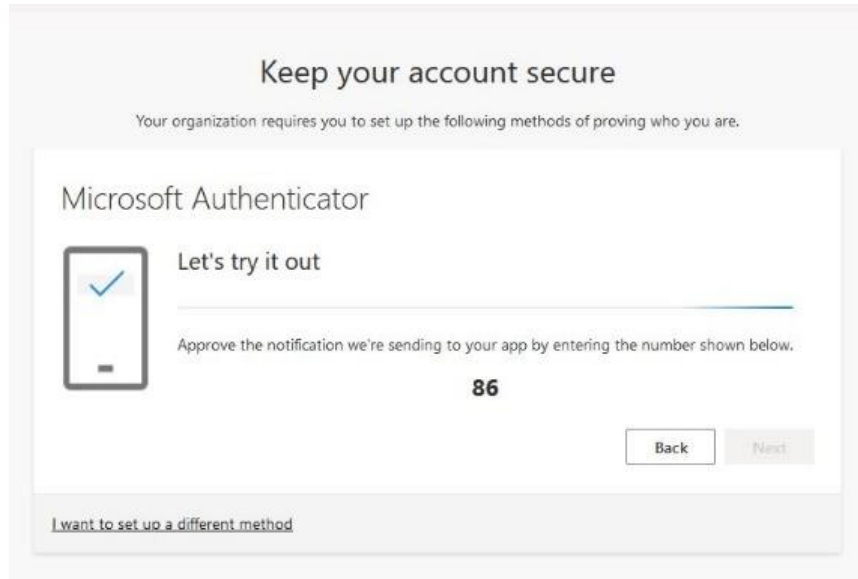

23. Microsoft will now send you a test number match notification to your mobile device

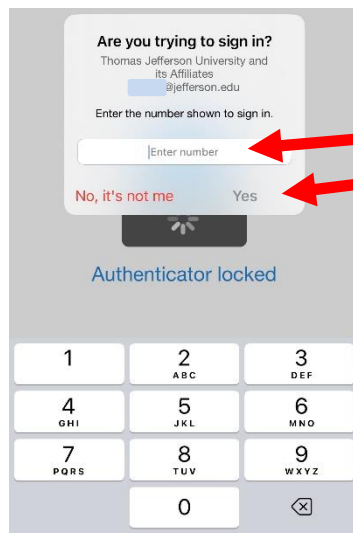

24. Go to your **mobile** device and find the notification and type in the number shown on the screen, in my example above, the number is 86. Your number will be unique to you and different each time. Note: If you don't see the notification, close Microsoft Authenticator app and reopen the app and it should appear. If you still don't see it, wait some time and it will time out and ask to send it again.

25. After entering the unique number, push **YES** (second **arrow** in above photo)

26. Then it might say "Notification Approved"

27. Go back to the **computer**, your screen will look like this below



28. Click **Next**

29. You have completed adding your device

FAQs

App lock and how to disable it

1. Open the Microsoft Authenticator app and click on the Menu button in the upper left hand corner. If you have an Android device the menu button is on the right.



2. Go to the Security section and toggle off the App Lock setting

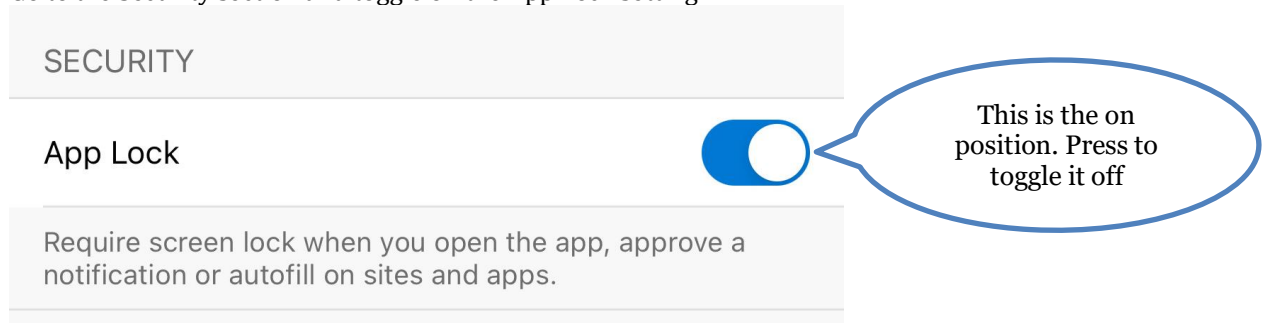

What should I do if I get a random Microsoft Authenticator notification

PLEASE READ

If you are sure this is not you logging in and a session is not currently refreshing, please click No, it's not me and then Report. Please note, this **WILL** block your account from using MFA. Please contact the Solution Center 215-955-7975 to assist with looking over your account and putting in a ticket to unblock your account. You can also ignore the message (closing out the window) and call the Solution Center for assistance.

1. If you get a random Microsoft Authenticator notification on your mobile device and you believe it to be suspicious, please click **No, it's not me** as shown below

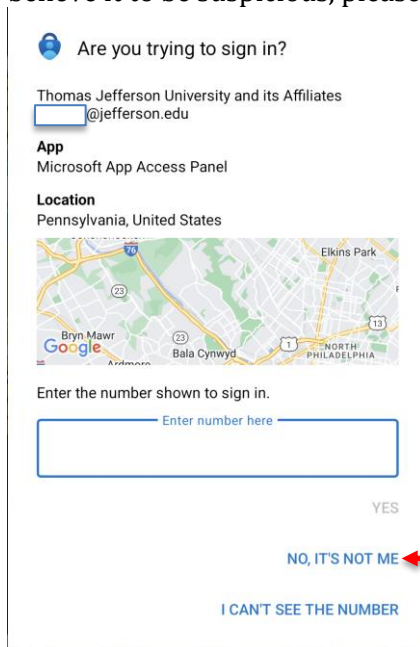

Are you trying to sign in?

Thomas Jefferson University and its Affiliates
[redacted]@jefferson.edu

App
Microsoft App Access Panel

Location
Pennsylvania, United States

Enter the number shown to sign in.

Enter number here

YES

NO, IT'S NOT ME

I CAN'T SEE THE NUMBER

2. A warning screen will appear

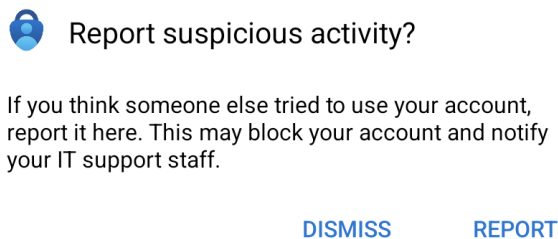

Report suspicious activity?

If you think someone else tried to use your account, report it here. This may block your account and notify your IT support staff.

DISMISS REPORT

If you select Report, it will block your account. You must contact Solution Center and reference that you selected to report and block your MFA account.